

Apr 08, 2021, 2:05:15pm - User: rebekeh.scorso  
 N:\PROJECTS\2551 SARAH & AMR BASTIAROUS\2551.01 THE MAPLE GROVE RESIDENCE\PHASE 03 - PERMIT ASSISTANCE\CAD\2551-LA2.3 WALL DRAIN PLAN-MARLE PERM.DWG

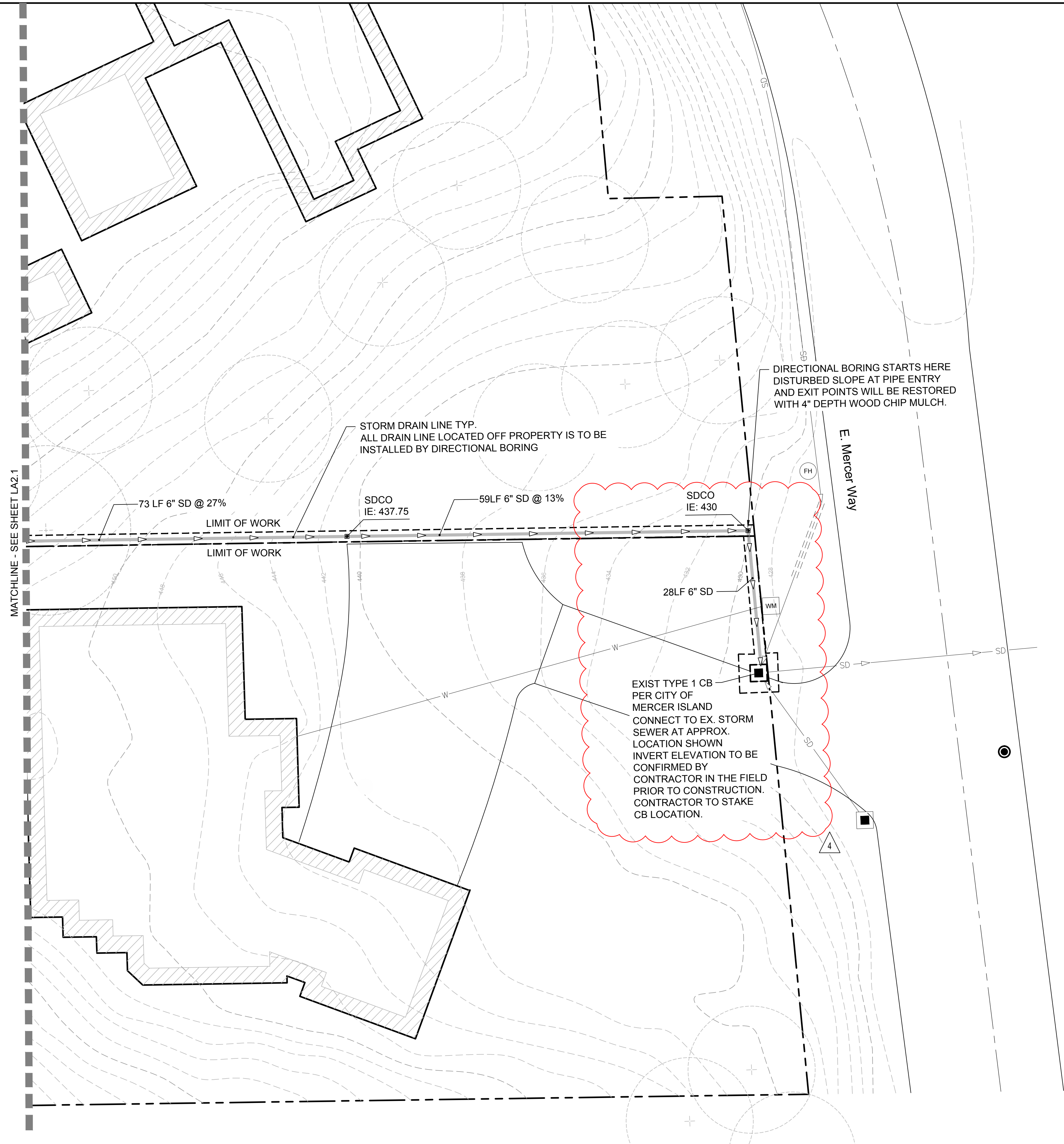

DIRECTIONAL BORING STARTS HERE  
 DISTURBED SLOPE AT PIPE ENTRY  
 AND EXIT POINTS WILL BE RESTORED  
 WITH 4" DEPTH WOOD CHIP MULCH.

STORM DRAIN LINE TYP.  
 ALL DRAIN LINE LOCATED OFF PROPERTY IS TO BE  
 INSTALLED BY DIRECTIONAL BORING

EXIST TYPE 1 CB  
 PER CITY OF  
 MERCER ISLAND  
 CONNECT TO EX. STORM  
 SEWER AT APPROX.  
 LOCATION SHOWN  
 INVERT ELEVATION TO BE  
 CONFIRMED BY  
 CONTRACTOR IN THE FIELD  
 PRIOR TO CONSTRUCTION.  
 CONTRACTOR TO STAKE  
 CB LOCATION.

**ABBREVIATIONS:**

- CB: CATCH BASIN
- FTG: FOOTING DRAIN LINE
- IE: INVERT ELEVATION
- LF: LINEAR FEET
- SD: STORM DRAIN LINE
- SDCO: STORM DRAIN CLEANOUT

**NOTES:**

1. ALL WORK SHALL BE DONE IN ACCORDANCE WITH CITY OF MERCER ISLAND CURRENT STANDARD SPECIFICATINOS
2. CONTRACTOR TO PROVIDE AS-BUILT STORM SEWER SYSTEM TO CITY OF MERCER ISLAND UPON COMPLETION
3. UNLESS OTHERWISE NOTED SD PIPE SHALL BE 6" HDPE PIPE RIGID W/ SMOOTH WALL INTERIOR. SD SHALL BE AT 2.0% MINIMUM
3. UNLESS OTHERWISE NOTED FTG PIPE SHALL BE 6" SCH 80 PERFORATED DRAIN PIPE, FTG PIPE SHALL BE AT 2.0% MINIMUM
4. CONTRACTOR TO DIRECTIONAL BORE ALL PROPOSED PIPE LOCATIONS THAT ARE OFF PROPERTY
5. CONTRACTOR TO TUNNEL BORE OR AIR EXCAVATE WITHIN DRIPLINE OF TREES
6. CONTRACTOR TO ENGAGE CITY OF MERCER ISLAND ARBORIST WHILE PERFORMING GRADING WITHIN DRIPLINE OF TREES
7. ALL EXCAVATED SOILS NOT USED IN THE BACKFILL OF THE DRAINAGE TRENCH WILL NOT BE ALLOWED TO REMAIN ON THE SLOPE.
8. ALL DRILLING FLUID AND CUTTINGS ASSOCIATED WITH DIRECTIONAL DRILLING CANNOT BE DISPOSED OF ON SITE.

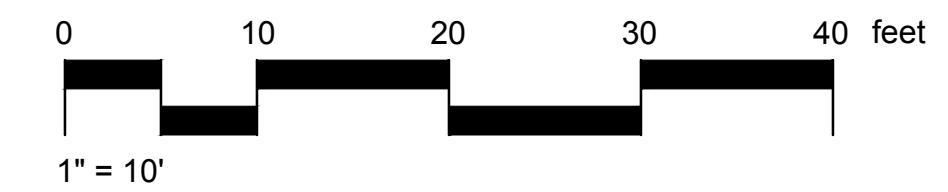
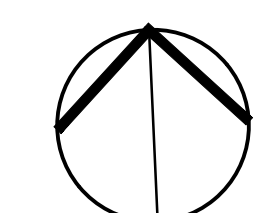

| REVISIONS                                | DATE       | BY |
|--|------------|----|
| △ PERMIT PLAN                            | 10/17/2019 | KJ |
| △ PERMIT PLAN - 2ND SUBMITTAL            | 11/23/2020 | RR |
| △ PERMIT PLAN - 3RD SUBMITTAL            | 3/10/2021  | RR |
| △ PERMIT PLAN - 3RD SUBMITTAL CORRECTION | 4/08/2021  | RR |

**SCJ STUDIO**  
 LANDSCAPE ARCHITECTURE

1148 NW LEARY WAY, SEATTLE, WA 98107  
 P. 206.709.1666  
 SCJSTUDIO.COM

**Wall Drain Plan**

**Maple Grove Residence**  
 4909 E. Mercer Way  
 Mercer Island, WA 98040

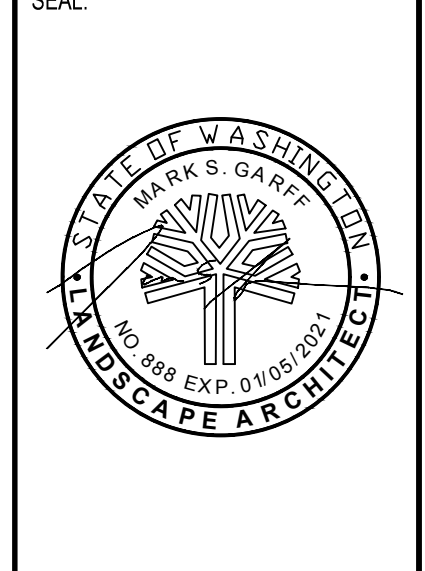

DESIGNER: KJ  
 DRAWN BY: RR  
 APPROVED BY: MG  
 DATE: April 8, 2021  
 JOB No: 2551  
 DRAWING FILE No:  
 DRAWING No: LA2.4  
 SHEET No: 6 OF 10